

4-Bike Carrier Assembly Instructions

Recommended tools for assembly (not included):



Wrench
Size: 19 mm

STEP 1: Attach main support tube (1) to the mounting bracket (2). Line up the hole near the end of main support tube with the hole on the mounting bracket. Install **hex bolt (3)**, **2 nylon flat washers (4)**, and **locknut (5)** as shown. Tighten locknut until it's tight. Main support tube must rotate after tightening.

STEP 2: Re-install **bail pin (6)** through mounting bracket and main support tube so the bike carrier is in upright position.

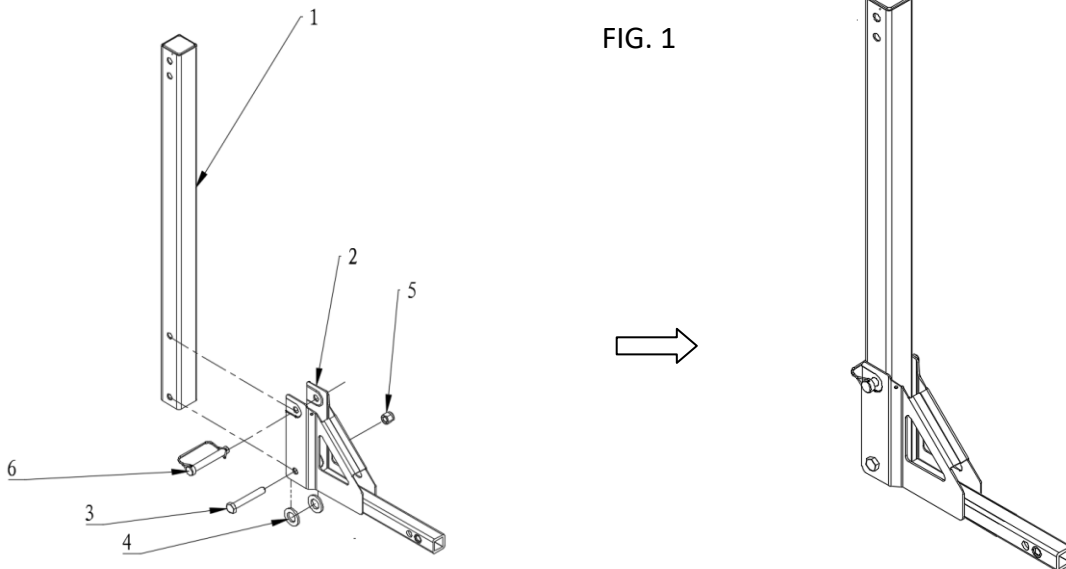

STEP 3: Pull bail pin (6) from mounting bracket and arm assembly (7), Attach arm assembly to main support tube with hex bolt (3), and locknut (5) as shown. Line up the hole at the end of support tube with the hole in the arm assembly. Re-install bail pin through arm assembly and main support tube.

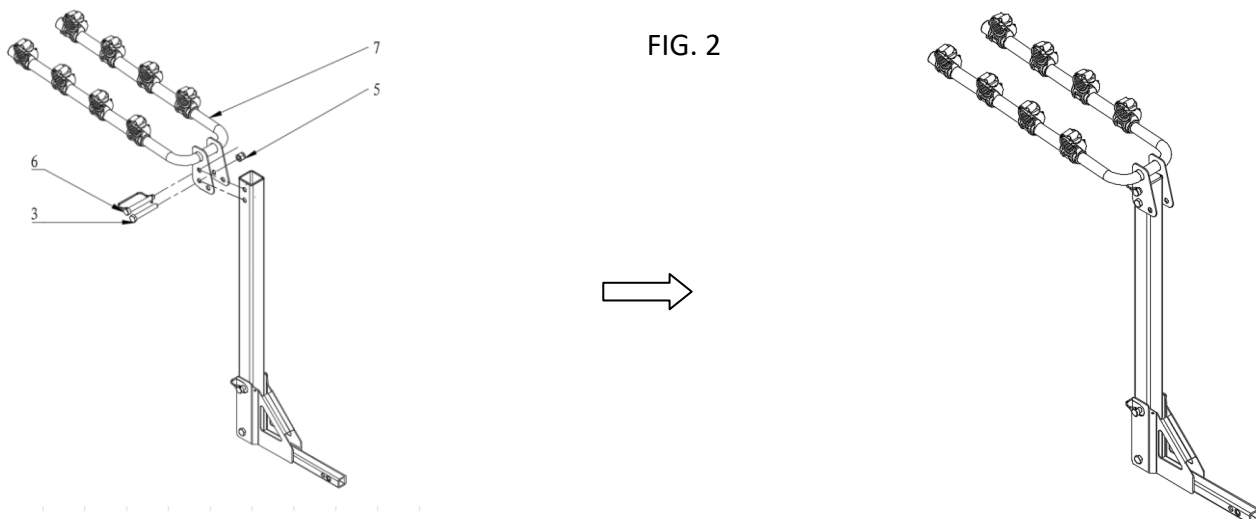

Vehicle Mounting Instructions:

1. For a 1-1/4" Receiver hitch use **anti-rattle pin (9)**, **spring washer (11)**, **flat washer (10)** and **pin clip (12)** as shown. Tighten with 19mm wrench (not provided).
2. For a 2" Receiver hitch use **2" Adapter (8)**, **anti-rattle pin (9)**, **spring washer (11)**, **flat washer (10)** and **pin clip (12)** as shown. Tighten with 19mm wrench or socket (not provided).

FIG. 3

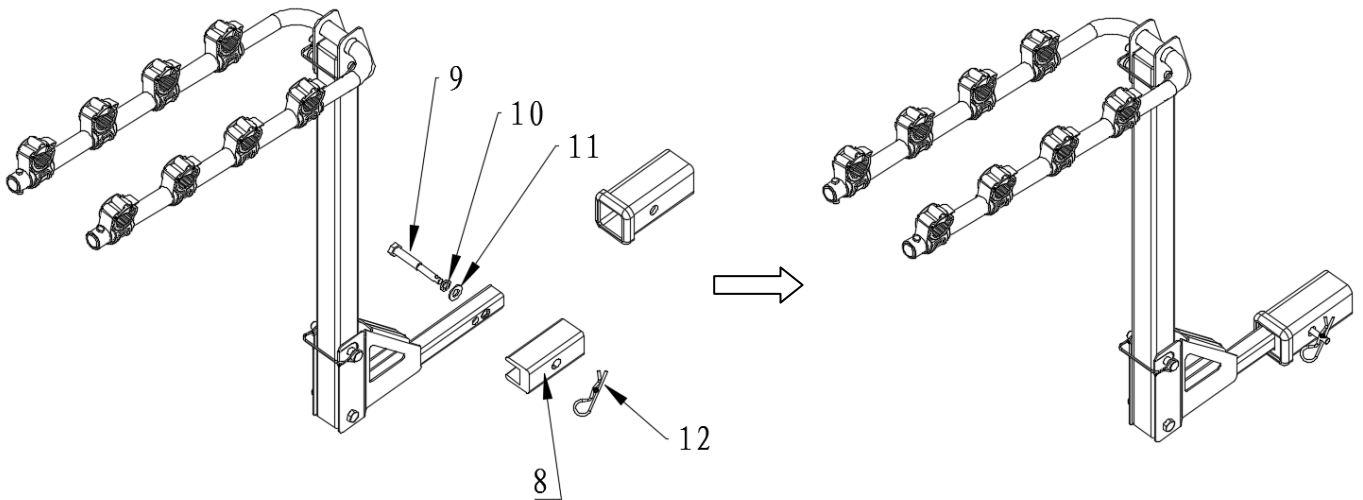

Exploded View:

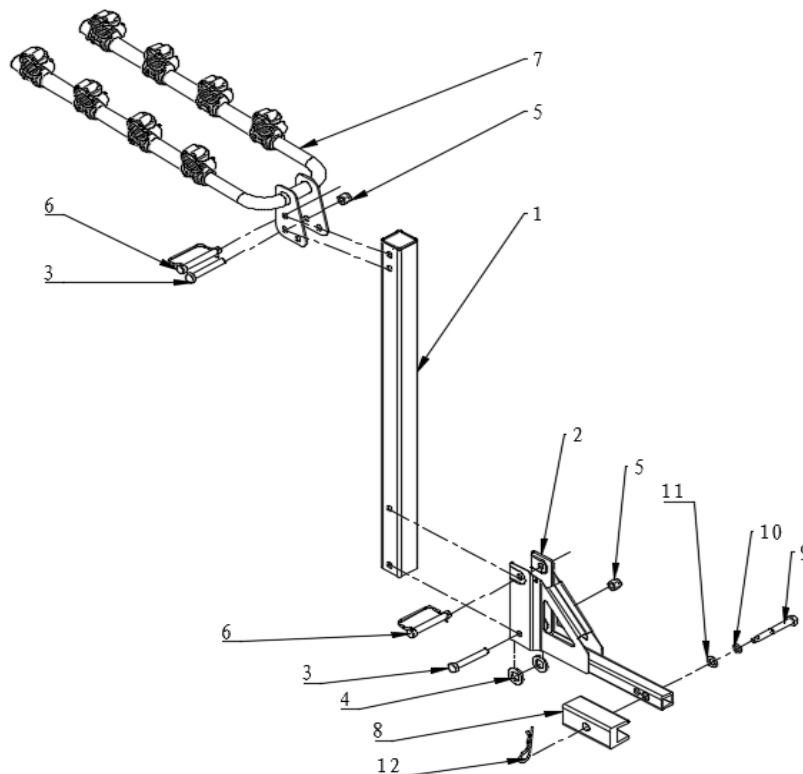

Part List

Part #	Description	Qty	Part #	Description	Qty
1	Main Support Tube	1	7	Arm Assembly	1
2	mounting bracket	1	8	2" Adapter	1
3	Hex Bolt	2	9	Anti-Rattle Pin	1
4	Nylon Washers	2	10	Spring Washer	1
5	Lock Nut	2	11	Flat Washer	1
6	Bail Pin	2	12	Pin Clip	1

Strap Closure Instructions:



WARNING

To prevent serious injury or death:

INSPECT for signs of wear, corrosion and fatigue BEFORE each use. DO NOT use if bent or deformed.

DO NOT EXCEED the 120lb. (54kg) capacity of the bike carrier.

DO NOT use this carrier with recreational vehicles, trailers or in off-road situations.

SAVE THESE INSTRUCTIONS